

# QUADRODEC®

## Quadrodec® Rectangular rigid duct 220X55mm - 0,5m

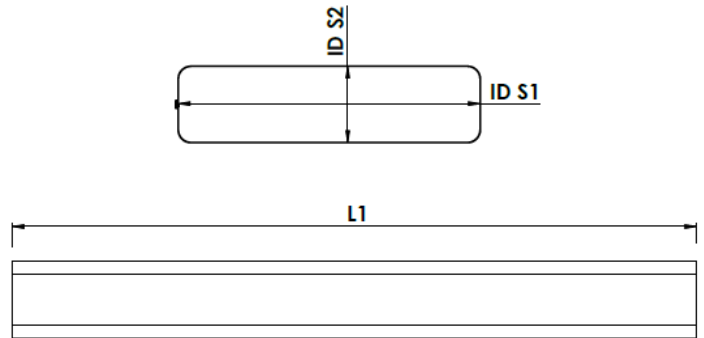

Order code: QDP220X55/0,5



### Description

Rigid rectangular duct, both sides female connection. Can be used for creating rectangular ductwork or placing an air valve directly on one side.

Connection: Female/Female  
Material: DX53D, Zinc plated 275g/m<sup>2</sup>  
EN ISO 9227:2006

### Classification

EN 13501-1:2018: Class A1  
EN 1507: Leakage Class D/(ATC2)  
Ansi Ashrae 120-2017: Pressure loss

### Leakage

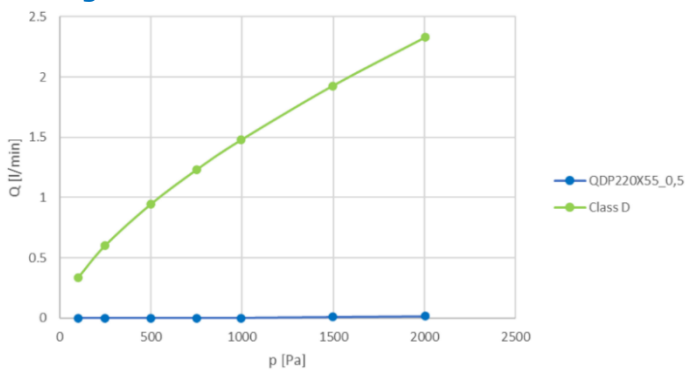

The rectangular sides of this fitting are easy to assemble with our unique DEC® Safe connector **QDCMM220X55**.

Also available in 250X80mm.

ID S1	ID S2	L1
mm	mm	mm
220	55	500
±0,5	±0,5	±20

### Pressure loss

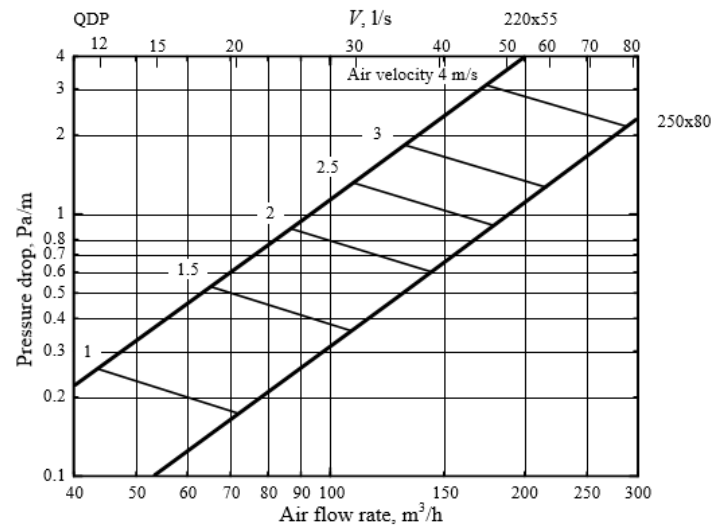

#### LIABILITY:

The information contained in this brochure was current on the publication date. DEC INTERNATIONAL reserves the right to make changes in details at any time without prior notice. In order to avoid misunderstandings, any interested party is advised to contact DEC INTERNATIONAL checking for any changes in materials and/or information after this brochure was published.

#### PLEASE NOTICE:

The consultant is responsible for the actual installation and mounting of the product. The mentioned values with respect to temperatures are not appropriate to be used to determine the physical properties. These properties are also dependent on humidity and the temperature of the air inside and outside of the H.V.A.C. system.

#### TRADEMARKS:

QUADRODEC, the DEC logo and DEC International are trademarks or registered trademarks of Dutch Environment Corporation BV in the Netherlands and/or other countries.

#### RESTRICTIONS:

The QUADRODEC ducts are not suitable for discharging combustion products from open fireplaces and oil-fired boilers. Neither are the ducts suitable for transporting air with a high concentration of acid and base.

