

# QUADRODEC®

## Quadrodec® Round semi-flexible Galva duct F/F Ø160mm - 1,0m

Order code: QDCO3DSDX(80)160/1,0



### Description

Robust electrolytically galvanized semi-flexible duct with pressed female connection for creating round ductwork or placing an air valve directly on one side.

Connection: Female/Female  
Material duct: 80µm galvanized strip  
Galvanized strip: EN10152 2,0-3,0µm Zinc plated  
Material of end caps: DX53D, Zinc plated 275g/m<sup>2</sup>  
Working temperature up to: 375°C.

### Classification

EN 13501-1:2018 Class A1  
EN 12237: Leakage Class D/(ATC2)  
Ansi Ashrae 120-2017: Pressure loss

The dependence of volume flow  $Q$  and pressure drop  $\Delta p$  for dry air at a temperature of  $t=20$  °C and pressure of  $p=101325$  Pa, i.e. for air density of  $\rho=1.2$  kg/m<sup>3</sup>.

EN 12237 ("Ventilation for buildings - Ductwork - Strength and leakage of circular sheet metal ducts"), duct was classified in one of four airtightness classes A, B, C or D.

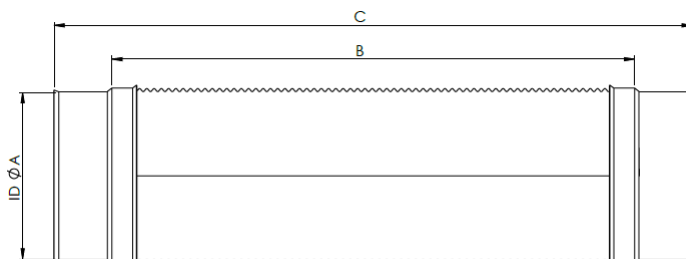

← Extendable to max. 1500mm →

ID ØA	B	C
mm	mm	mm
160	1000	1080
-0/+0,5	-40/+0	-40/+0

Ideal for bridging differences in distance, this channel can be extended to 1,5 X 1000mm.

### Leakage

The dependencem of air leakage factor  $f$  on the duct wall and overpressure  $p_m$  in the duct.

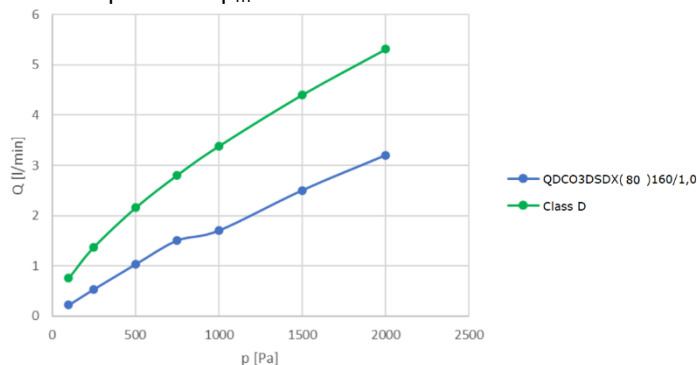

#### LIABILITY:

The information contained in this brochure was current on the publication date. DEC INTERNATIONAL reserves the right to make changes in details at any time without prior notice. In order to avoid misunderstandings, any interested party is advised to contact DEC INTERNATIONAL checking for any changes in materials and/or information after this brochure was published.

#### PLEASE NOTICE:

The consultant is responsible for the actual installation and mounting of the product. The mentioned values with respect to temperatures are not appropriate to be used to determine the physical properties. These properties are also dependent on humidity and the temperature of the air inside and outside of the H.V.A.C. system.

#### TRADEMARKS:

QUADRODEC, the DEC logo and DEC International are trademarks or registered trademarks of Dutch Environment Corporation BV in the Netherlands and/or other countries.

#### RESTRICTIONS:

The QUADRODEC ducts are not suitable for discharging combustion products from open fireplaces and oil-fired boilers. Neither are the ducts suitable for transporting air with a high concentration of acid and base.



## Pressure loss

The pressure drop  $\Delta p$  straight and bends with three different curvatures for duct.

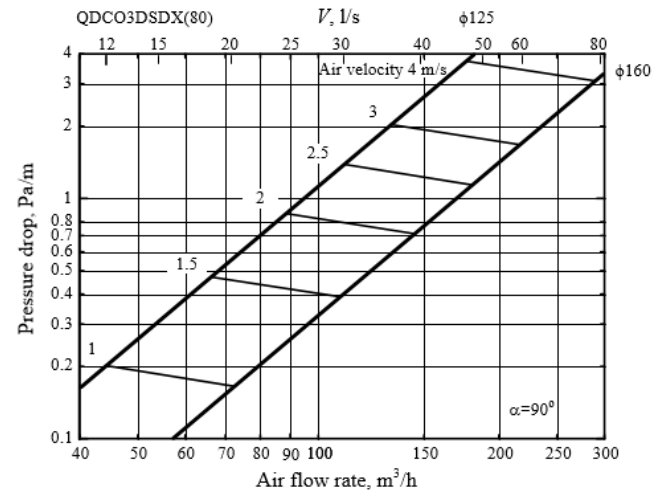
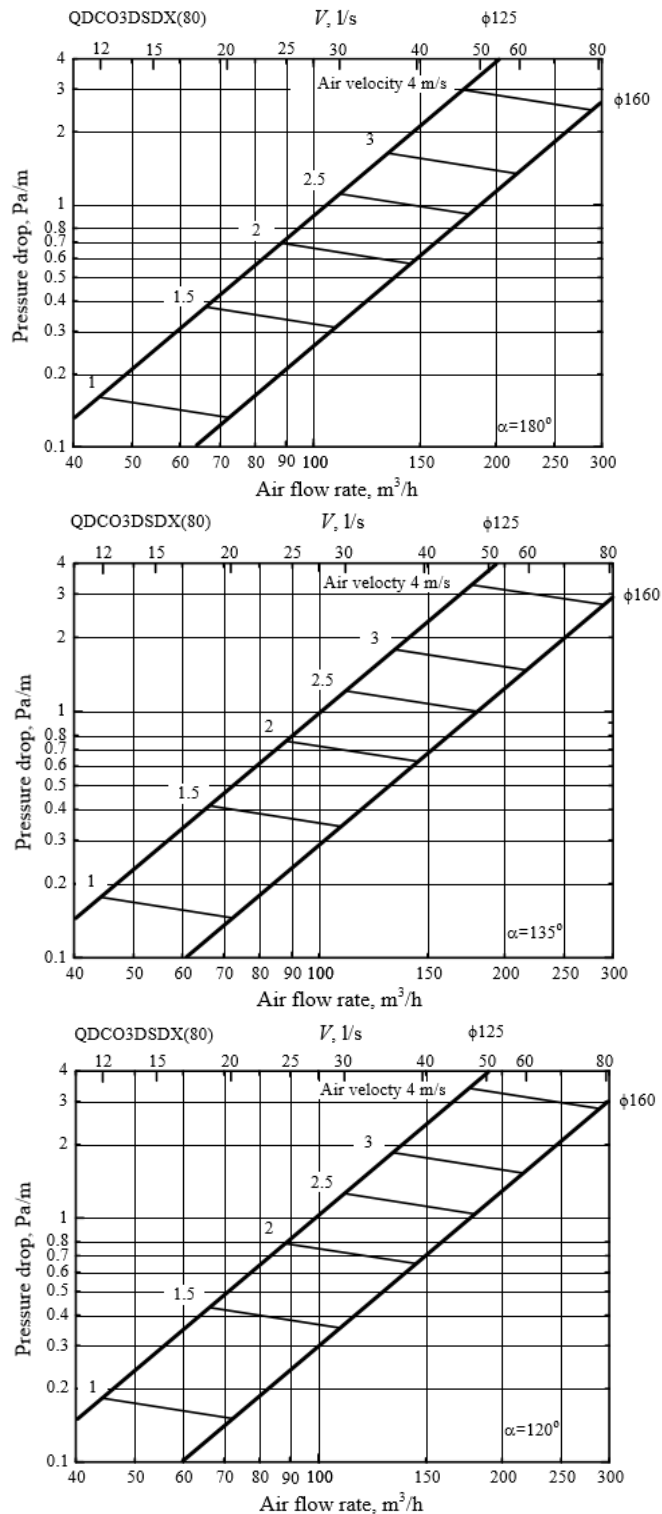

Also available in diameter  $\varnothing 125$ mm.

### LIABILITY:

The information contained in this brochure was current on the publication date. DEC INTERNATIONAL reserves the right to make changes in details at any time without prior notice. In order to avoid misunderstandings, any interested party is advised to contact DEC INTERNATIONAL checking for any changes in materials and/or information after this brochure was published.

### PLEASE NOTICE:

The consultant is responsible for the actual installation and mounting of the product. The mentioned values with respect to temperatures are not appropriate to be used to determine the physical properties. These properties are also dependent on humidity and the temperature of the air inside and outside of the H.V.A.C. system.

### TRADEMARKS:

QUADRODEC, the DEC logo and DEC International are trademarks or registered trademarks of Dutch Environment Corporation BV in the Netherlands and/or other countries.

### RESTRICTIONS:

The QUADRODEC ducts are not suitable for discharging combustion products from open fireplaces and oil-fired boilers. Neither are the ducts suitable for transporting air with a high concentration of acid and base.

