

# QUADRODEC®

## Quadrodec® Connector Rectangular 250X80mm

Order code: QDCMM250X80

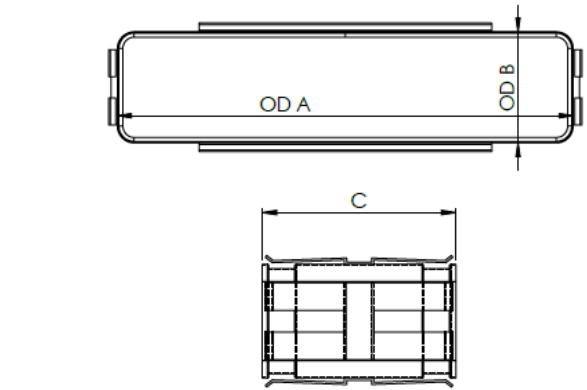

OD A	OD B	C
mm	mm	mm
248	78	90
±0,5	±0,5	

### Description

Unique connector with EPDM, with four-sided clamping element to support the leakage class D/(ATC2). Can be used universally for all rectangular female connections with the same nominal dimension of the Quadrodec system.

Connection: Male/Male  
Material: DX53D, Zinc plated 275g/m<sup>2</sup>  
EN ISO 9227:2006

DEC® Safe connection: EPDM, fixed connection  
IEC 60695-2-11:2014 (TÜV)  
REACH, ROHs (TÜV)

### Classification

EN 13501-1:2018: Class A1  
EN 12237: Leakage Class D/(ATC2)  
Ansi Ashrae 120-2017: Pressure loss

### Leakage

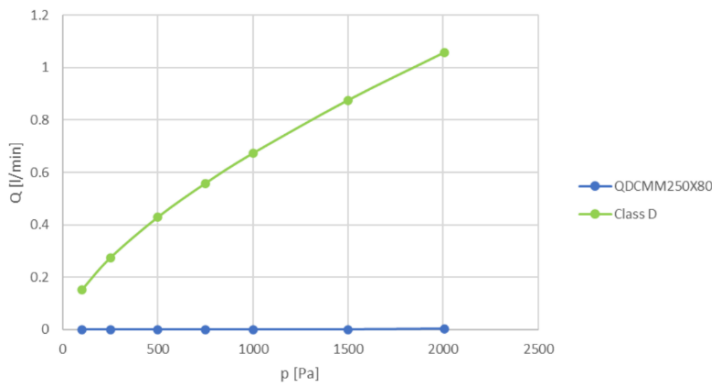

Also available in 220X55mm.

### Pressure loss

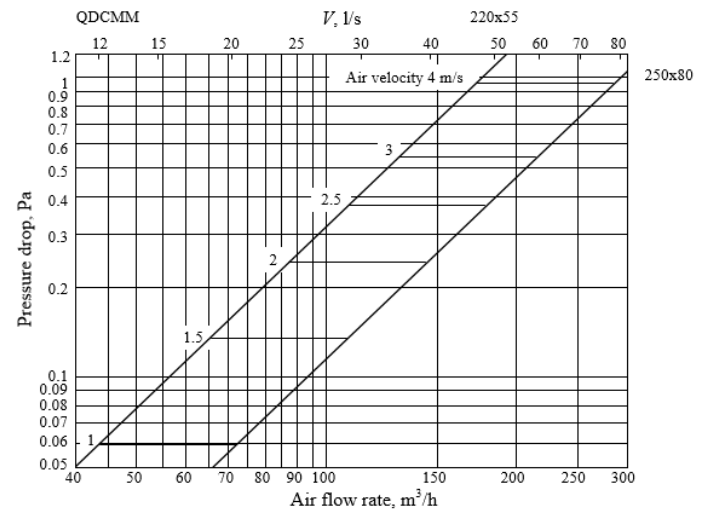

#### LIABILITY:

The information contained in this brochure was current on the publication date. DEC INTERNATIONAL reserves the right to make changes in details at any time without prior notice. In order to avoid misunderstandings, any interested party is advised to contact DEC INTERNATIONAL checking for any changes in materials and/or information after this brochure was published.

#### PLEASE NOTICE:

The consultant is responsible for the actual installation and mounting of the product. The mentioned values with respect to temperatures are not appropriate to be used to determine the physical properties. These properties are also dependent on humidity and the temperature of the air inside and outside of the H.V.A.C. system.

#### TRADEMARKS:

QUADRODEC, the DEC logo and DEC International are trademarks or registered trademarks of Dutch Environment Corporation BV in the Netherlands and/or other countries.

#### RESTRICTIONS:

The QUADRODEC ducts are not suitable for discharging combustion products from open fireplaces and oil-fired boilers. Neither are the ducts suitable for transporting air with a high concentration of acid and base.

